

# EXHIBIT A

---

## LEGAL DESCRIPTION

### Municipal Improvement District Area - Avenue "C" and 28<sup>th</sup> Street

That portion of the Northeast quarter (NE $\frac{1}{4}$ ) of Section 1, Township 9 South, Range 24 West of the Gila and Salt River Base and Meridian, Yuma County, Arizona, more particularly described as follows:

BEGINNING at the Northeast corner of said Section 1;

THENCE South 00°21'03" East along the East line of the Northeast quarter of said Section 1 a distance of 2,503.30 feet to the TRUE POINT OF BEGINNING;

THENCE continuing South 00°21'03" East along the East line of the Northeast quarter of said Section 1 a distance of 136.42 feet to the Southeast corner of the Northeast quarter of said Section 1;

THENCE South 89°57'07" West along the South line of the Northeast quarter of said Section 1 a distance of 2,650.84 feet to the Southwest corner of the Northeast quarter of said Section 1;

THENCE North 00°15'44" West along the West line of the Northeast quarter of said Section 1 a distance of 142.77 feet;

THENCE North 89°44'16" East a distance of 61.00 feet;

THENCE South 45°09'19" East a distance of 106.26 feet;

THENCE North 89°57'07" East parallel with and 68.00 feet northerly of the South line of the Northeast quarter of said Section 1 a distance of 175.00 feet;

THENCE South 00°15'44" East a distance of 18.00 feet;

THENCE North 89°57'07" East parallel with and 50.00 feet northerly of the South line of the Northeast quarter of said Section 1 a distance of 218.68 feet;

THENCE North 44°50'01" East a distance of 35.28 feet;

THENCE North 00°17'04" West a distance of 17.76 feet;

THENCE North 89°42'56" East a distance of 58.00 feet;

THENCE South 45°09'59" East a distance of 35.43 feet;

THENCE North 89°57'07" East parallel with and 68.00 feet northerly of the South line of the Northeast quarter of said Section 1 a distance of 275.00 feet;

THENCE South 00°21'03" East a distance of 18.00 feet;

THENCE North 89°57'07" East parallel with and 50.00 feet northerly of the South line of the Northeast quarter of said Section 1 a distance of 869.37 feet;

THENCE North 44°48'02" East a distance of 35.26 feet;

THENCE North 00°21'03" West a distance of 17.69 feet;

THENCE North 89°38'57" East a distance of 58.00 feet;

THENCE South 45°11'58" East a distance of 35.45 feet;

THENCE North 89°57'07" East parallel with and 68.00 feet northerly of the South line of the Northeast quarter of said Section 1 a distance of 230.66 feet;

THENCE South 00°21'03" East a distance of 12.00 feet;

THENCE North 89°57'07" East parallel with and 56.00 feet northerly of the South line of the Northeast quarter of said Section 1 a distance of 290.00 feet;

THENCE North 00°21'03" West a distance of 5.00 feet;

THENCE North 89°57'07" East parallel with and 61.00 feet northerly of the South line of the Northeast quarter of said Section 1 a distance of 85.00 feet;

THENCE North 44°48'02" East a distance of 105.79 feet;

THENCE North 89°38'57" East a distance of 80.00 feet to the TRUE POINT OF BEGINNING.

Containing 4.0163 acres, more or less.



EXHIBIT B

Municipal Improvement District  
Assessment Diagram  
of Park West Units 4 and 5

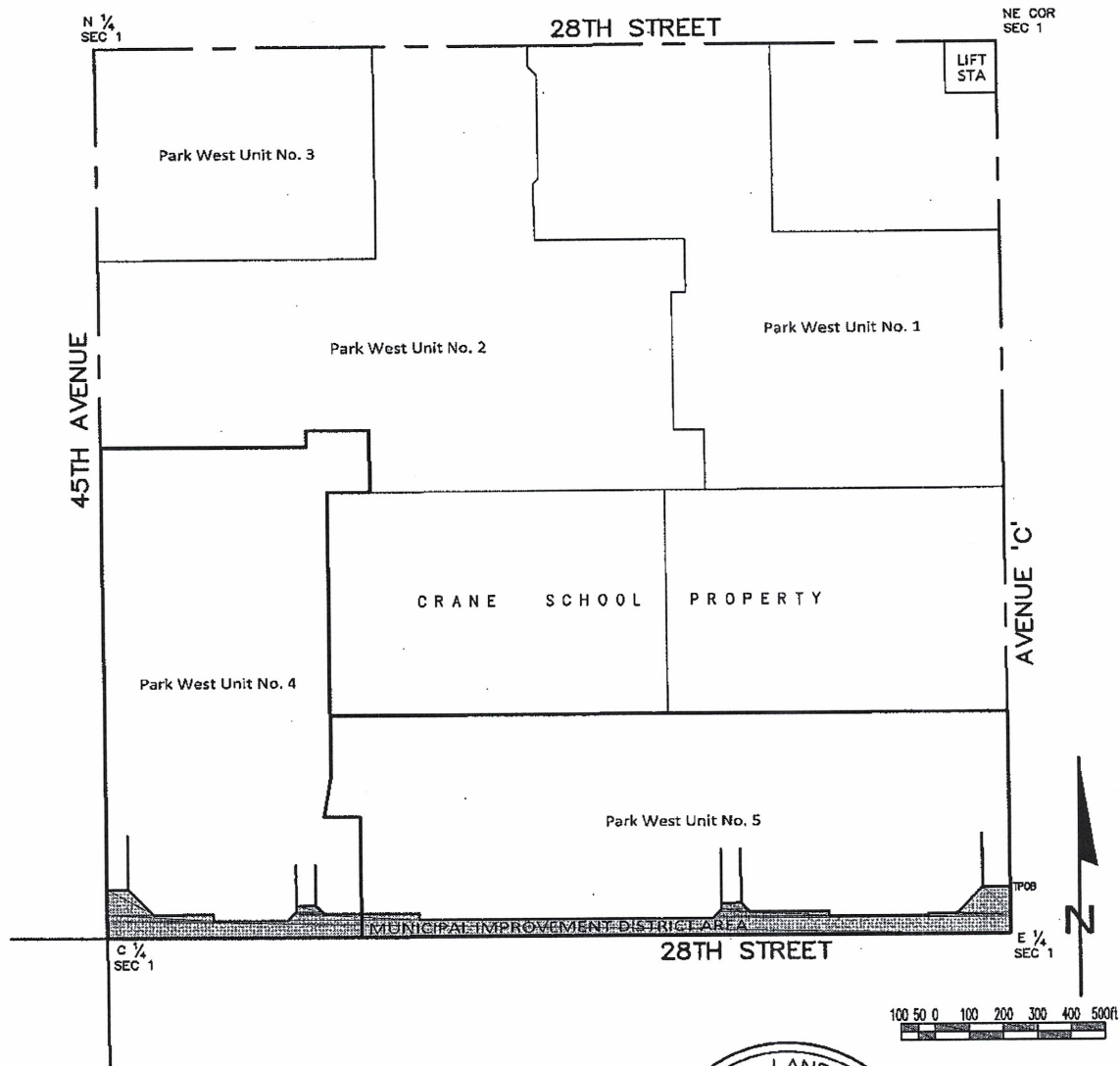

Note:

This improvement district is formed for the express purpose of providing the maintenance and operation of the sidewalks, landscaping, retention basins, and related improvements adjacent to and along the public roadways and parkways within the district.



Expires 3/31/2018